

LighTile

Lighting modules

LighTiles consist of a laser-engraved, edge-lit acrylic substrate (Prismex™). The LighTiles have to be equipped with extra-flat, COB technology-based LEDLine modules, whereby the RGB versions enable LighTiles to be produced in any desired light colour.

Depending on the required light output, between one and all four sides of the LighTiles can be edge-lit.

LighTiles are ideal for ceiling- or wall-mounted accent or decorative lighting, but are also suitable for functional lighting needs, e.g. for illuminated advertisements, information panels and emergency exit signs.

The Ref. No. quoted below refer to the acrylic LighTiles with a custom-fitted and assembled aluminium frame. The LEDLine PCBs must be ordered separately to suit the given assembly.

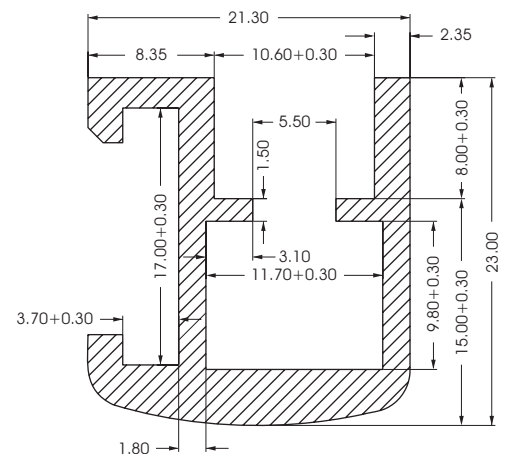
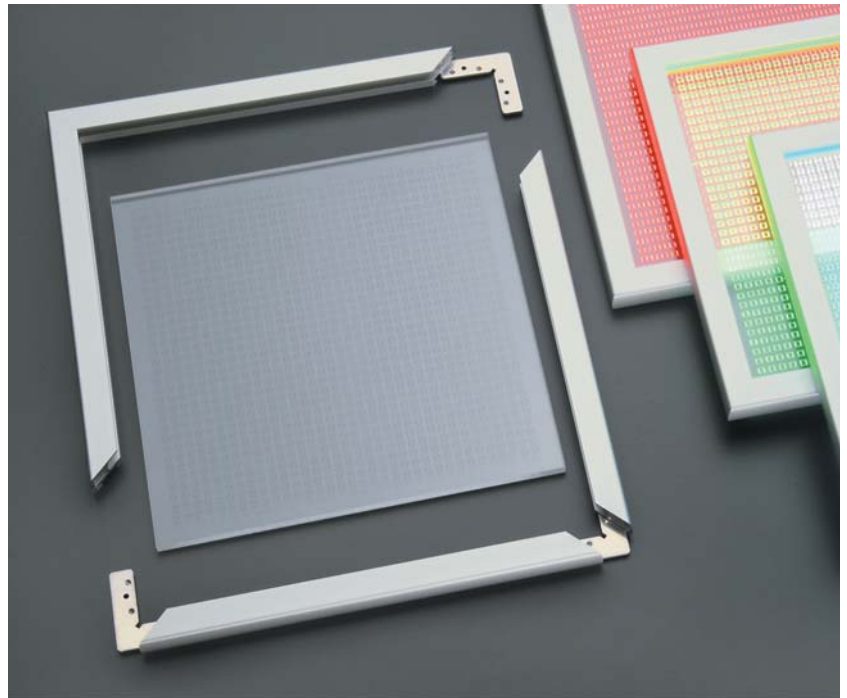

Frame

LighTile (acrylic substrate and frame)						
Type	Ref. No.	Weight kg	Dimensions of the acrylic substrate		Dimensions incl. frame	
			Length (mm)	Width (mm)	Length (mm)	Width (mm)
WU-LT-300x300	505170	1.6	300	300	330	330
WU-LT-600x300	534025	2.5	600	300	630	330
WU-LT-600x600	505183	5.2	600	600	630	630
WU-LT-900x600	505185	7.6	900	600	930	630
WU-LT-900x900	505192	13.0	900	900	930	930