



A New Lighting Experience



- overload protection
- overheating protection
- short circuiting protection
- 50,000 hrs service life time

LED Converters

LEDLine EDX

Electronic converters
for voltage driven LED modules

Vossloh-Schwabe Deutschland GmbH

Hohe Steinert 8 · 58509 Lüdenscheid, Germany · Phone: +49 (0) 23 51/101-0
Fax: +49 (0) 23 51/101-217 + -384 · www.vossloh-schwabe.com

LEDLine EDXe 110

Electronic converter for Light Emitting Diodes

The very small disc-form control component was principally developed for individual applications. It can be integrated into a luminaire or be housed in a flush box. VS converters are electronically protected against overload, overheating and short-circuiting.



Shape: dia. 58x19 mm
 Weight: 70 g
 Mains voltage: 230/240 V
 Mains frequency: 50–60 Hz
 Protection against "no load" operation
 Protection class II
 SELV-equivalent
 Power factor: 0.5

EN 61347-1; EN 61347-2-13 (Safety)
 EN 61000-3-2 (Mains Harmonics)
 EN 55015 (Non radio disturbance)
 EN 61547 (EMC Immunity Requirements)

Service life time: 50,000 hrs
 permanent operation when maximum temperature t_{cmax} at t_c point will not be exceeded;
 failure rate: < 0.2% per 1,000 hrs

Converter EDXe 110

Output: 0.1–10 W
 Voltage output: 24 V \pm 1 V
 Output current: 0.4 A
 Ambient temperature t_a : 0 to 45 °C
 Casing temperature t_c : 80 °C
 Leads, white:
 prim.: 2x0.75 mm², length: 150 mm
 sec.: 2x0.75 mm², length: 478 mm
 brown: +
 blue: -

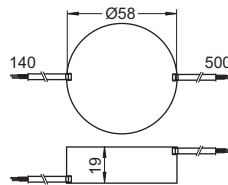

Degree of protection: IP20

Ref. No.: 186055

The values contained in this data sheet can change due to technical innovations. Any such changes will be made without separate notification. Please find further detailed information at www.vsslosh-schwabe.com.

LEDLine EDXe 112

Electronic converters for Light Emitting Diodes

Vossloh-Schwabe's LEDLine EDXe 112/12 V converter is a control component with a voltage output of 12 V and an output of up to 12 W for operating LED applications. The converter is electronically protected against overload, overheating and short-circuiting.



Shape: 103.5x36x22 mm
 Weight: 60 g
 Mains voltage: 220/240 V
 Mains frequency: 50–60 Hz
 Protection against "no load" operation
 Protection class II
 SELV-equivalent
 Degree of protection: IP20
 Power factor: 0.57

EN 61347-1; EN 61347-2-13 (Safety)
 EN 61000-3-2 (Mains Harmonics)
 EN 55015 (Non radio disturbance)
 EN 61547 (EMC Immunity Requirements)
 EN 62384 (Performance)

Service life time: 50,000 hrs
 permanent operation when maximum temperature
 t_{cmax} at t_c point will not be exceeded;
 failure rate: < 0.2 % per 1,000 hrs

Converter EDXe 112

Output: 0.1–12 W
 Voltage output: 12 V \pm 0.6 V
 Output current: 1 A
 Ambient temperature t_a : -20 to 50 °C
 Casing temperature t_c : 75 °
 Connections:
 prim.: 2 x screw terminals 2.5 mm²
 sec.: 2 x screw terminals 2.5 mm²

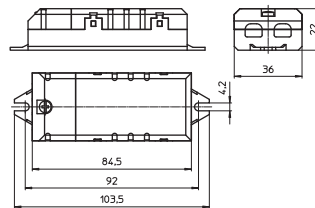

Ref. No.: 186204

LEDLine EDXe 120

Electronic converters for Light Emitting Diodes

Vossloh-Schwabe's LEDLine EDXe 120/24 V converter is a control component with a voltage output of 24 V and an output of up to 20 W for operating LED applications. The converter is pre-assembled with a mains lead on primary side for easy connection. The converter is electronically protected against overload, overheating and short-circuiting.



Shape: 182x42x18 mm
 Weight: 155 g
 Mains voltage: 220/240 V
 Mains frequency: 50–60 Hz
 Protection against "no load" operation
 Protection class II
 SELV-equivalent
 Degree of protection: IP20
 Power factor: 0.5

EN 61347-1; EN 61347-2-13 (Safety)
 EN 61000-3-2 (Mains Harmonics)
 EN 55015 (Non radio disturbance)
 EN 61547 (EMC Immunity Requirements)

Service life time: 50,000 hrs
 permanent operation when maximum temperature t_{cmax} at t_c point will not be exceeded;
 failure rate: < 0.2% per 1,000 hrs

Converter EDXe 120

Output: 0.1–20 W
 Voltage output: 24 V \pm 0.5 V
 Output current: 0.85 A
 Ambient temperature t_a : 0 to 45 °C
 Casing temperature t_c : 75 °
 Connections:
 prim.: mains connection cable, length: 1.48 m
 sec.: screw terminals 1.5 mm²

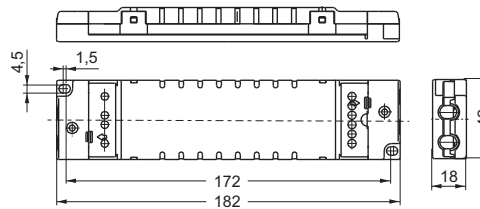

Ref. No.: 186129

The values contained in this data sheet can change due to technical innovations. Any such changes will be made without separate notification. Please find further detailed information at www.vsslosh-schwabe.com.

LEDLine EDXe 130

Electronic converters for Light Emitting Diodes

Vossloh-Schwabe's LEDLine EDXe 130 converter is a control component with a voltage output of 12 or 24 V and an output of up to 30 W for operating LED applications. The converters are electronically protected against overload, overheating and short-circuiting.



Shape: 200x42x25 mm
 Fixing distance: 190.5 mm
 Weight: 495 g
 Mains voltage: 110/240 V
 Mains frequency: 50–60 Hz
 Mains current: 330/150 mA
 Protection against "no load" operation
 Ambient temperature t_a : -20 to 60 °C
 Casing temperature t_c : 85 °C
 Output: 6–30 W
 Degree of protection: Casing IP54
 Protection class I
 SELV-equivalent
 Power factor: 0.95

EN 61347-1; EN 61347-2-13 (Safety)
 EN 61000-3-2 (Mains Harmonics)
 EN 55015 (Non radio disturbance)
 EN 61547 (EMC Immunity Requirements)

Service life time: 50,000 hrs
 permanent operation when maximum temperature t_{cmax} . at t_c point will not be exceeded;
 failure rate: < 0.2% per 1,000 hrs

Converter EDXe 130/24 V

Voltage output: 24 V \pm 0.5 V
 Output current: 1.25 A
 Conductor cross section 0.75 mm²
 prim.: three-core with earth terminal, length: 1 m, brown: L1, blue: N, yellow/green: earth
 sec.: 1 connection lead, length: 1 m, brown: +, blue: -

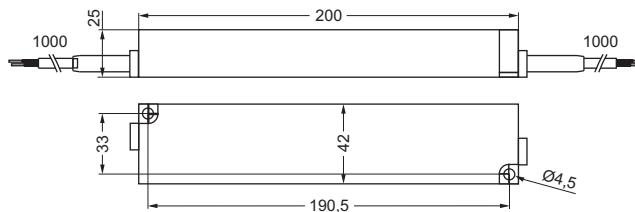

Ref. No.: 186058

Converter EDXe 130/12 V

Voltage output: 12 V \pm 0.5 V
 Output current: 0.5–2.5 A
 Conductor cross section 0.75 mm²
 prim.: three-core with earth terminal, length: 1 m, brown: L1, blue: N, yellow/green: earth
 sec.: 2 connection leads, length: 1 m/0.3 m, brown: +, blue: -

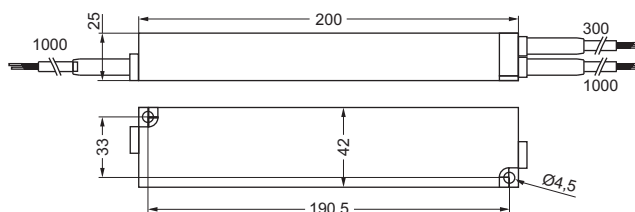

Ref. No.: 186107 VDE

Ref. No.: 186106 UL

LEDLine EDXe 170/24 V

Electronic converters for Light Emitting Diodes

Vossloh-Schwabe's LEDLine EDXe 170/24 V converter is a control component with a voltage output of 24 V and an output of up to 70 W for operating LED applications.

The converters are electronically protected against overload, overheating and short-circuiting.



Mains voltage: 220/240 V
Mains frequency: 50–60 Hz
Mains current: 360/310 mA
Protection against "no load" operation
Degree of protection: IP20
Protection class I
SELV-equivalent
Power factor: 0.97

EN 61347-1; EN 61347-2-13 (Safety)
EN 61000-3-2 (Mains Harmonics)
EN 55015 (Non radio disturbance)
EN 61547 (EMC Immunity Requirements)

Service life time: 50,000 hrs
permanent operation when maximum temperature t_{cmax} at t_c point will not be exceeded;
failure rate: < 0.2% per 1,000 hrs

Converter EDXe 170/24 V

Shape: 170x60x36 mm
Fixing distance: 178 mm
Weight: 340 g
Ambient temperature t_a : -20 to 45 °C
Casing temperature t_c : 70 °C
Output: 0–70 W
Voltage output: 24 V \pm 0.48 V
Output current: 0–2.9 A
Push-in terminals with push button:
2.5 mm² solid lead

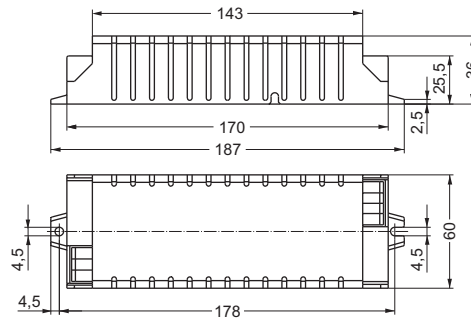

Ref. No.: 186103

Converter EDXe 170/24 V with cord grip

Shape: 224x60x36 mm
Fixing distance: 210 mm
Weight: 360 g
Ambient temperature t_a : -20 to 45 °C
Casing temperature t_c : 70 °C
Output: 0–70 W
Voltage output: 24 V \pm 0.48 V
Output current: 0–2.9 A
Push-in terminals with push button:
2.5 mm² solid lead
Cord grip approved for
mains leads: HO3 WF 3x0.75 mm²
or NYM 3x1.5 mm²
output leads: SIHY-Cu 4x1 mm²
or SIHSI-Cu 4x1 mm²

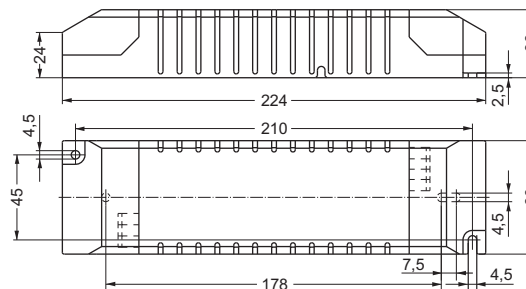

Ref. No.: 186104

The values contained in this data sheet can change due to technical innovations. Any such changes will be made without separate notification. Please find further detailed information at www.vs-optoelectronic.com.

LEDLine EDXe 170/24 V IP67

Electronic converters for Light Emitting Diodes

Vossloh-Schwabe's LEDLine EDXe 170/24 V IP67 converter is a control component with a voltage output of 24 V and an output of up to 70 W for operating LED applications.

The converter is electronically protected against overload, overheating and short-circuiting.

Mains voltage: 220/240 V
Mains frequency: 50–60 Hz
Mains current: 360/310 mA
Protection against "no load" operation
Degree of protection: casing IP67
Protection class I
SELV-equivalent
Power factor: 0.97



EN 61347-1; EN 61347-2-13 (Safety)
EN 61000-3-2 (Mains Harmonics)
EN 55015 (Non radio disturbance)
EN 61547 (EMC Immunity Requirements)

Service life time: 50,000 hrs
permanent operation when maximum temperature
 t_{cmax} . at t_c point will not be exceeded;
failure rate: < 0.2% per 1,000 hrs

Converter EDXe 170/24 V IP67

Shape: 225x65.6x51 mm
Fixing distance: 235 mm
Weight: 515 g
Ambient temperature t_a : -20 to 45 °C
Casing temperature t_c : 70 °C
Output: 0–70 W
Voltage output: 24 V \pm 0.48 V
Output current: 0–2.9 A
Pre-assembled connection:
prim.: 3x1 mm², H05RN-F, 500 mm
sec.: 2x2 mm², SO7RN-F, 500 mm

Ref. No.: 186105

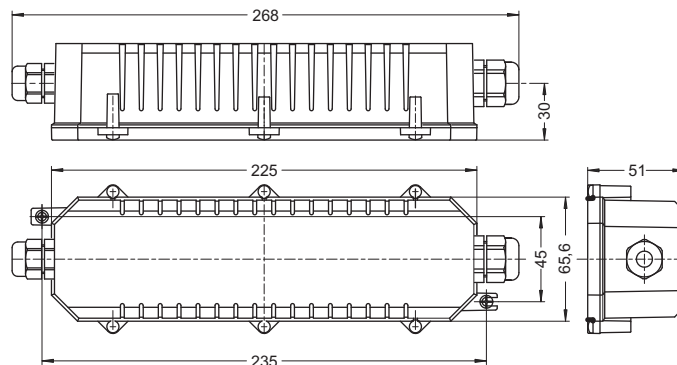

LEDLine EDXe 170/12 V

Electronic converters for Light Emitting Diodes

Vossloh-Schwabe's LEDLine EDXe 170/12 V converter is a control component with a voltage output of 12 V and an output of up to 70 W for operating LED applications.

The converters are electronically protected against overload, overheating and short-circuiting.



Mains voltage: 220/240 V
 Mains frequency: 50–60 Hz
 Mains current: 365/335 mA
 Protection against "no load" operation
 Degree of protection: IP20
 Protection class I
 SELV-equivalent
 Power factor: 0.97

EN 61347-1; EN 61347-2-13 (Safety)
 EN 61000-3-2 (Mains Harmonics)
 EN 55015 (Non radio disturbance)
 EN 61547 (EMC Immunity Requirements)

Service life time: 50,000 hrs
 permanent operation when maximum temperature t_{cmax} at t_c point will not be exceeded;
 failure rate: < 0.2% per 1,000 hrs

Converter EDXe 170/12 V

Shape: 183x61x49 mm
 Fixing distance: 191 mm
 Weight: 340 g
 Ambient temperature t_a : -20 to 45 °C
 Casing temperature t_c : 70 °C
 Output: 0–70 W
 Voltage output: 12.1 V \pm 0.24 V
 Output current: 0–5.8 A
 Push-in terminals with push button:
 2.5 mm² solid lead

Ref. No.: 186112

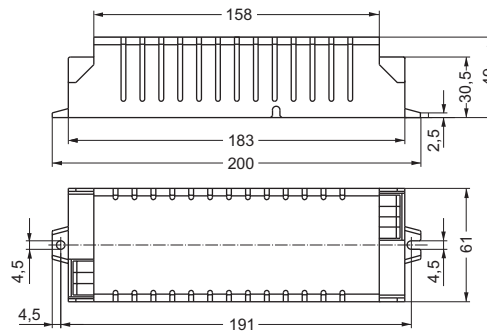

Converter EDXe 170/12 V with cord grip

Shape: 245x61x49 mm
 Fixing distance: 231 mm
 Weight: 360 g
 Ambient temperature t_a : -20 to 45 °C
 Casing temperature t_c : 70 °C
 Output: 0–70 W
 Voltage output: 12.1 V \pm 0.24 V
 Output current: 0–5.8 A
 Push-in terminals with push button:
 2.5 mm² solid lead
 Cord grip approved for
 mains leads: HO3 WF 3x0.75 mm²
 or NYM 3x1.5 mm²
 output leads: SIHY-Cu 4x1 mm²
 or SIHS-Cu 4x1 mm²

Ref. No.: 186113

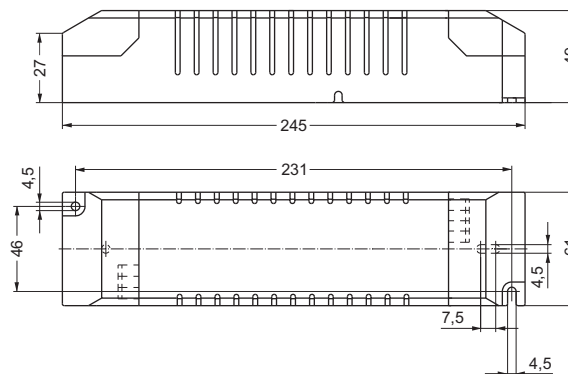

The values contained in this data sheet can change due to technical innovations. Any such changes will be made without separate notification. Please find further detailed information at www.vs-optoelectronic.com.

LEDLine EDXe 170/12 V IP67

Electronic converters for Light Emitting Diodes

Vossloh-Schwabe's LEDLine EDXe 170/12 V IP67 converter is a control component with a voltage output of 12 V and an output of up to 70 W for operating LED applications.

The converter is electronically protected against overload, overheating and short-circuiting.

Mains voltage: 220/240 V

Mains frequency: 50–60 Hz

Mains current: 365/335 mA

Protection against "no load" operation

Degree of protection: IP67

Protection class I

SELV-equivalent

Power factor: 0.97



EN 61347-1; EN 61347-2-13 (Safety)

EN 61000-3-2 (Mains Harmonics)

EN 55015 (Non radio disturbance)

EN 61547 (EMC Immunity Requirements)

Service life time: 50,000 hrs

permanent operation when maximum temperature

t_{cmax} at t_c point will not be exceeded;

failure rate: < 0.2% per 1,000 hrs

Converter EDXe 170/12 V IP67

Shape: 225x65.6x51 mm

Fixing distance: 235 mm

Weight: 515 g

Ambient temperature t_a : -20 to 45 °C

Casing temperature t_c : 70 °C

Output: 0–70 W

Voltage output: 12.1 V \pm 0.24 V

Output current: 0–5.8 A

Pre-assembled connection:

prim.: 3x1 mm², H05RN-F, 500 mm

sec.: 2x2 mm², SO7RN-F, 500 mm

Ref. No.: 186114

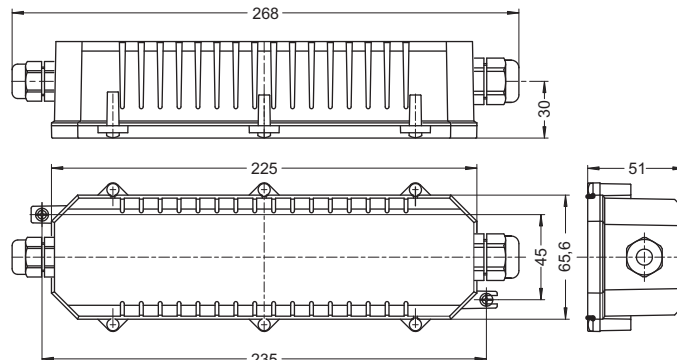

LEDLine EDXe 1130/24 V

Electronic converters for Light Emitting Diodes

Vossloh-Schwabe's LEDLine EDXe 1130/24 V converter is a control component with a voltage output of 24 V and an output of up to 130 W for operating LED applications.

The converters are electronically protected against overload, overheating and short-circuiting.



Mains voltage: 220/240 V
Mains frequency: 50–60 Hz
Mains current: 640/585 mA
Protection against "no load" operation
Degree of protection: IP20
Protection class I
SELV
Power factor: 0.98

EN 61347-1; EN 61347-2-13 (Safety)
EN 61000-3-2 (Mains Harmonics)
EN 55015 (Non radio disturbance)
EN 61547 (EMC Immunity Requirements)

Service life time: 50,000 hrs
permanent operation when maximum temperature
 t_{cmax} at t_c point will not be exceeded;
failure rate: < 0.2% per 1,000 hrs

Converter EDXe 1130/24 V

Shape: 183x61x49 mm
Fixing distance: 194.5 mm
Weight: 370 g
Ambient temperature t_a : -20 to 45 °C
Casing temperature t_c : 75 °C
Output: 0–130 W
Voltage output: 24 V \pm 0.48 V
Output current: 0–5.4 A
Push-in terminals with push button:
2.5 mm² solid lead

Ref. No.: 186131

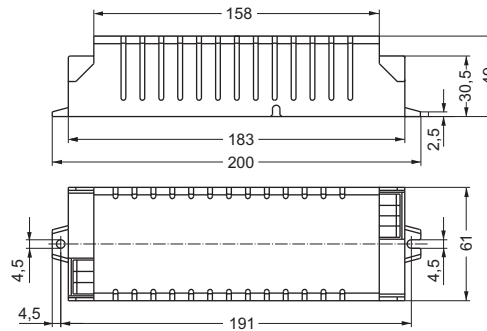

Converter EDXe 1130/24 V with cord grip

Shape: 245x61x49 mm
Fixing distance: 231 mm
Weight: 390 g
Ambient temperature t_a : -20 to 45 °C
Casing temperature t_c : 75 °C
Output: 0–130 W
Voltage output: 24.1 V \pm 0.48 V
Output current: 0–5.4 A
Push-in terminals with push button:
2.5 mm² solid lead
Cord grip approved for
mains leads: HO3 WF 3x0.75 mm²
or NYM 3x1.5 mm²
output leads: SIHY-Cu 4x1 mm²
or SIHS-Cu 4x1 mm²

Ref. No.: 186132

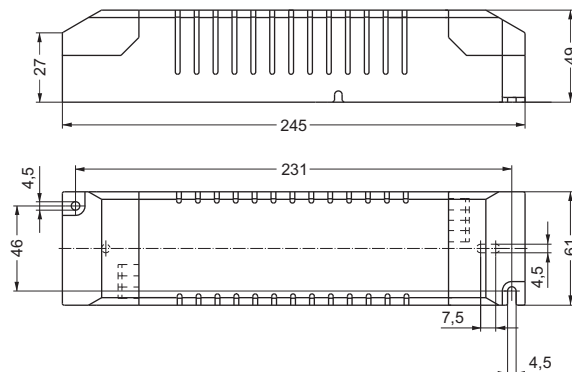

The values contained in this data sheet can change due to technical innovations. Any such changes will be made without separate notification. Please find further detailed information at www.vs-optoelectronic.com.

LEDLine EDXe 1130/24 V IP67

Electronic converters for Light Emitting Diodes

Vossloh-Schwabe's LEDLine EDXe 1130/24 V IP67 converter is a control component with a voltage output of 24 V and an output of up to 130 W for operating LED applications.

The converter is electronically protected against overload, overheating and short-circuiting.



Mains voltage: 220/240 V
Mains frequency: 50–60 Hz
Mains current: 640/585 mA
Protection against "no load" operation
Degree of protection: IP67
Protection class I
SELV
Power factor: 0.98

EN 61347-1; EN 61347-2-13 (Safety)
EN 61000-3-2 (Mains Harmonics)
EN 55015 (Non radio disturbance)
EN 61547 (EMC Immunity Requirements)

Service life time: 50,000 hrs
permanent operation when maximum temperature
 t_{cmax} at t_c point will not be exceeded;
failure rate: < 0.2% per 1,000 hrs

Converter EDXe 1130/24 V IP67

Shape: 225x65.6x51 mm
Fixing distance: 235 mm
Weight: 545 g
Ambient temperature t_a : -20 to 45 °C
Casing temperature t_c : 70 °C
Output: 0–130 W
Voltage output: 24.1 V \pm 0.48 V
Output current: 0–5.4 A
Pre-assembled connection:
prim.: 3x1 mm², H05RN-F, 500 mm
sec.: 2x2 mm², SO7RN-F, 500 mm

Ref. No.: 186133

